

you can  
**Canon**

**DR-4010C**  
Next Generation  
Document Scanner

Compact and robust  
high-performance scanning

DR-4010C



# Convenience and power in one compact package

The DR-4010C is a powerful desktop scanner that's small in size but big on performance. Incorporating a host of new technology it delivers superb image quality and class-leading colour scanning speeds. It's ideal for individuals and departments that need dependable performance and ease-of-use in one compact package.

## Compact design

A footprint measuring just 318mm x 278mm x 187mm makes the DR-4010C an incredibly compact departmental scanner that's one of the smallest in its class.



## Same speed scanning



Simplex, A4 portrait, 300dpi

## High speed scanning

An innovative 3-line CMOS sensor helps the DR-4010C to handle all your scanning needs at identical high-speeds. Colour, black and white, and greyscale images are scanned at a swift 42 images per minute and 84 images per minute using duplex mode. In addition, an auto colour detection function is incorporated, which detects which pages are in colour and which are in black-and-white and scans them accordingly. Documents with a combination of both therefore, can be instantly and accurately scanned in one complete batch - without needing to separate the pages first.

**DR-4010C**  
Small in size but  
big on performance.

## Superb image quality

The DR-4010C features a new shading mechanism, which ensures that - unlike some systems - paper dust cannot be accidentally adhered to the shading plate. So there are no unwelcome black lines on the images and no need for periodic cleaning of the shading plate to maintain quality. And as the 3-line CMOS sensor reads each RGB colour simultaneously, it's more accurate than traditional one-line sensing systems, resulting in a precise scanned image, with no colour staining.

## Easy-to-use

The DR-4010C is designed so that anyone can use it. An easy start guide gives users a step-by-step overview of set-up and ongoing operation. An on-screen panel enables simple tracking of every job. Using the job registration tool you can pre-program the job buttons for routine processes such as black-and-white duplex.

## Image enhancement

A number of easily-selectable modes allow you to enhance the scanned legibility of harder-to-read documents, using Canon's advanced text enhancement capabilities. Documents with patterned backgrounds, light text (such as pencil) on light backgrounds, and halftone backgrounds, can all be captured and improved. Similarly, on thin paper where the reverse side of a page is partly visible through the front, a bleed through function can be selected to prevent this occurring on the scanned image.

## Versatile scanning

The DR-4010C incorporates a useful facility which allows you to scan long documents up to 1000mm in length. The innovative design of the device enables it to offer two different paper paths for maximum versatility. A U-turn path accommodates standard business documentation such as invoices. Whilst a secondary document eject tray enables a straight paper path to be employed, meaning documents such as plastic cards, driving license cards, and similar media up to 489g/m<sup>2</sup> can be scanned.

Scan stock up to  
489g/m<sup>2</sup>

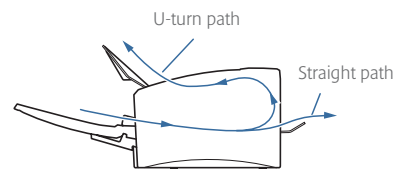

An added straight paper path enables smooth scanning of plastic cards and thick documents



Thumbnail images / Multi-window images

## Powerful Applications

A number of powerful applications are incorporated including Canon's CapturePerfect and Adobe Acrobat 7 Std.

42ppm



## Key features and benefits

- Incredibly compact, desktop scanning
- High speed colour and black and white scanning at 42 ppm
- Excellent image quality
- Auto-colour detection for mixed-batch document scanning
- Easy and dependable operation
- Powerful image enhancement facilities
- Straight paper path for heavy media up to 489g/m<sup>2</sup>
- Bundled software including Canon's CapturePerfect and Adobe Acrobat 7.0 Std

# Specifications DR-4010C

Type Document Reading Sensor Optical Resolution Light Source Reading Side Reading Speed (A4 200dpi Portrait) B&W Greyscale Colour	Desktop type sheet fed scanner  CMOS CIS 3 Line Sensor 600dpi RGB LED Front / Back / Duplex  42ppm (simplex) 84ipm (duplex) 42ppm (simplex) 84ipm (duplex) JPEG compression 42ppm (simplex) 84ipm (duplex) JPEG compression	
<b>DOCUMENT SIZE</b>	<b>U-Turn Path</b>	<b>Straight Path</b>
Width Length	53-219mm 70-356mm	
Thickness Automatic Feeding Bypass Mode	52-128g/m <sup>2</sup> (0.06-0.15mm) 42-157g/m <sup>2</sup> (0.05-0.20mm)	52-157g/m <sup>2</sup> (0.06-0.20mm) 42-546g/m <sup>2</sup> (0.05-0.66mm)
International Standard Card (Available at straight path with non-separation feed only) Width Length Thickness Long Document Mode (Adjustable in control panel) Thickness Image data size Document requirements  Creased paper	53.9mm 85.5mm 0.76mm*  1000mm max. 0.2mm or less 128MB or less 1) Pressure-sensitive paper: Can be fed with limitation of direction. 2) Carbon-backed paper: Cannot be fed. 3) Perforated paper for binder: Can be fed with limitation of holes. 4) Curled paper: Can be fed only if curl is 8mm or less. Can be fed, but crease must be straightened before being fed.	

DOCUMENT STORAGE	U-Turn Path	Straight Path
Pickup	10mm or less including curls (100 sheets or less with 80g/m <sup>2</sup> document)	
Eject Ejected face direction	12mm or less (Including curls) Face down	5mm or less (Including curls) Face up (Reverse ordering)
Paper separation Output Resolution Output Mode Binary Greyscale & Colour Interface Dimensions Tray closed Tray opened Weight Bundled Software Option Consumable Daily Duty Cycle	Retard Roller 100 x 100dpi, 150 x 150dpi, 200 x 200dpi, 240 x 240dpi, 300 x 300dpi, 400 x 400dpi, 600 x 600dpi  B&W/ Error Diffusion / High-Speed Text Enhancement / Advanced (Multistream is available) Text Enhancement: 2 type 8bit (256 level) Greyscale 24bit colour Dual Interface (SCSI-3 & High Speed USB2.0)  318 (W) x 278 (D) x 185.5 (H) mm 318 (W) x 545 (D) x 187 (H) mm at U-turn path Approx. 6.3kg ISIS/TWAIN Driver, CapturePerfect3.0, Adobe Acrobat7.0 Std Barcode Module II Exchange Roller Kit (Pick roller unit, Separation roller unit) Approx. 5,000 scans / day	
Some images are simulated for clarity of reproduction. All data is based on Canon's standard testing methods. This leaflet and the specifications of the product have been developed prior to the date of product launch. Final specifications are subject to change without notice.™ and ®: All company and/or product names are trademarks and/or registered trademarks of their respective manufacturers in their markets and/or countries. * No embossment is permitted		



Conforms to the International Energy Star program as an MFP



www.bsdp.canon-europa.com



Adobe Acrobat 7.0 Standard



you can  
**Canon**

Canon Inc.  
www.canon.com

Canon Europa N.V.  
www.canon-europe.com

© Canon Europa NV 2007



**Canon**

Conservation Partner